



R60  
Grandes roues de Prestige  
*Prestigious Big Wheels*





### **Main construction :**

The construction consisting out of eight (8) supporting masts, which are made out of round tubes, will support on a full size frame. These masts are put together in a so-called A-frame in opposite of each other. The space between the A-frame at ground level is the width of the Wheel, and the prescribed free space. The prescribed free space will be determined on the basis of safety calculations. The A-frame will be connected to the main axle of the Wheel at the highest point of the A-frame.



# Gondola

- The wheel has 42 fixed closed gondolas with a capacity of 6 persons each.
- Each gondola has a mechanical automatic open/closing system for the doors.
- The steel frame of the gondola is painted in a 3-layer system.
- The seats are made out of fibreglass in a non-metallic RAL colour.
- The gondola roof is made out of fibreglass in a non-metallic RAL colour.
- The decoration (including theme) on the bottom and side parts of the gondola is made out of Perspex (= screen plates).
- The windows of the upper part can be decorated with coloured stickers and are made out of lexan. Windows can be illuminated from inside (= optional, as described in point A.A.)



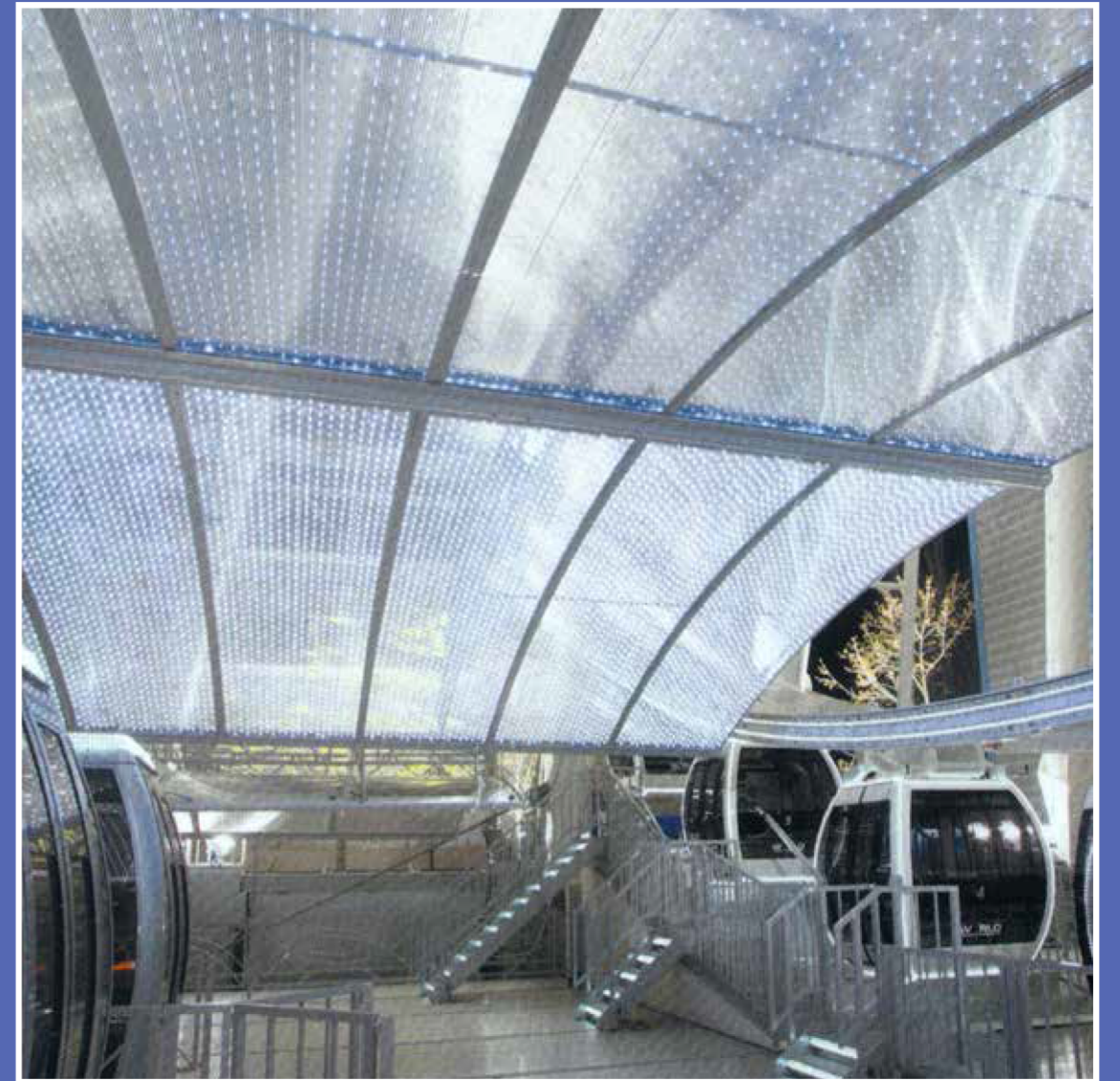
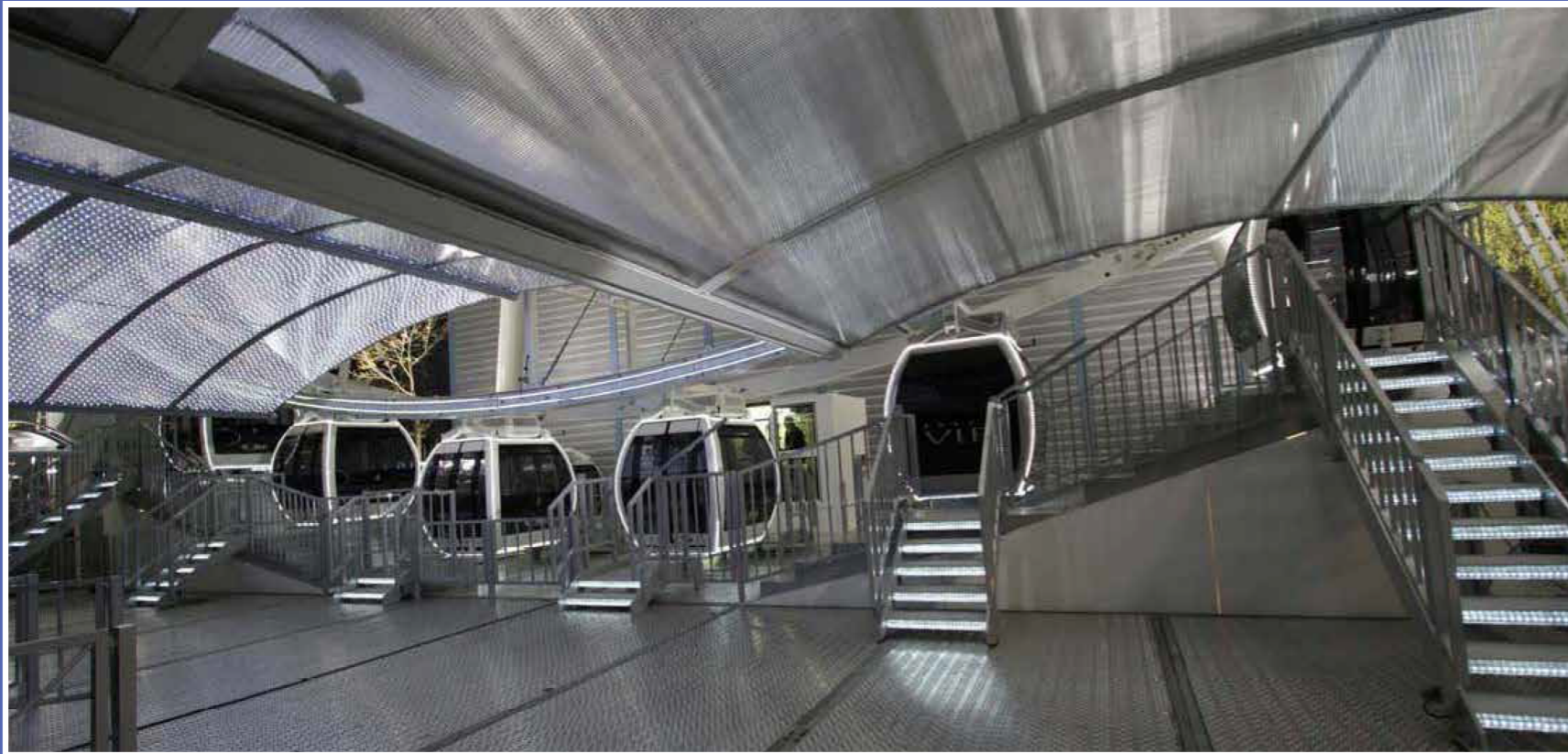

# Impression

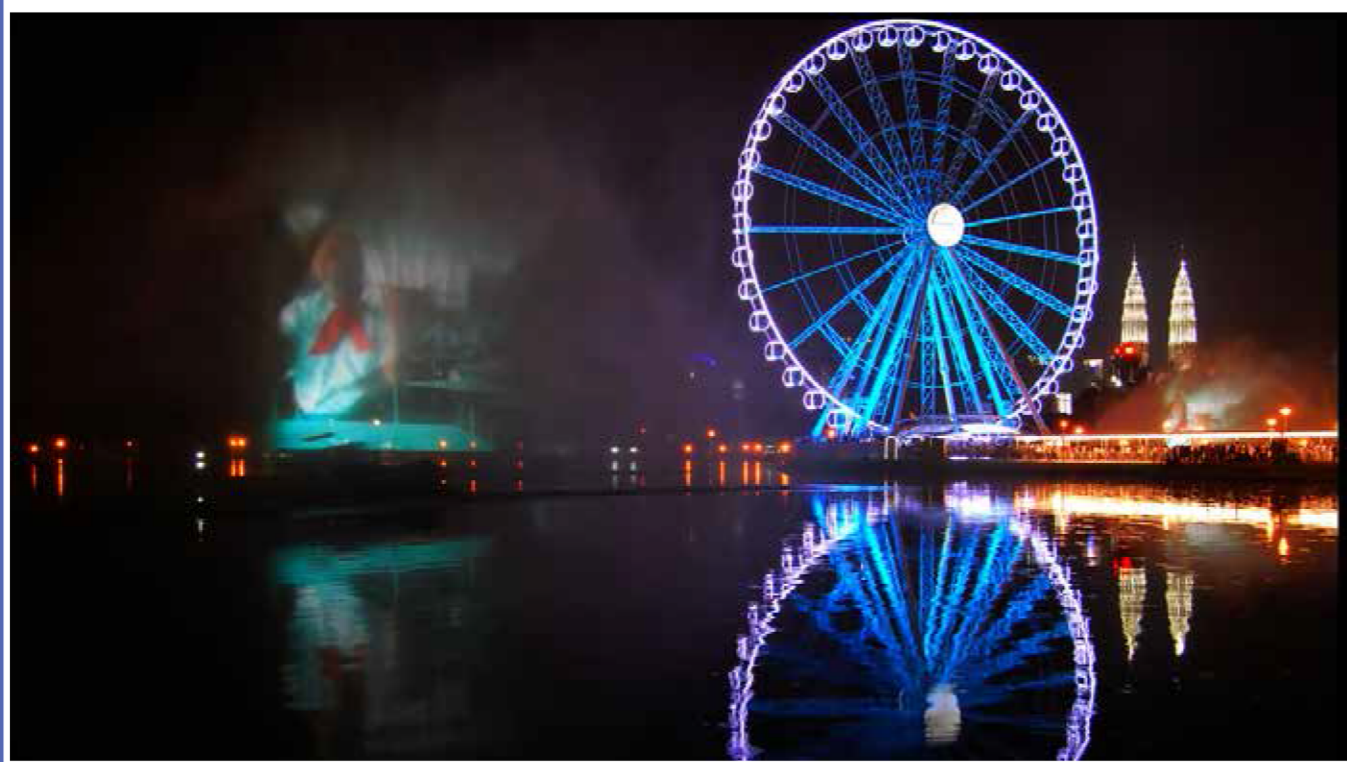



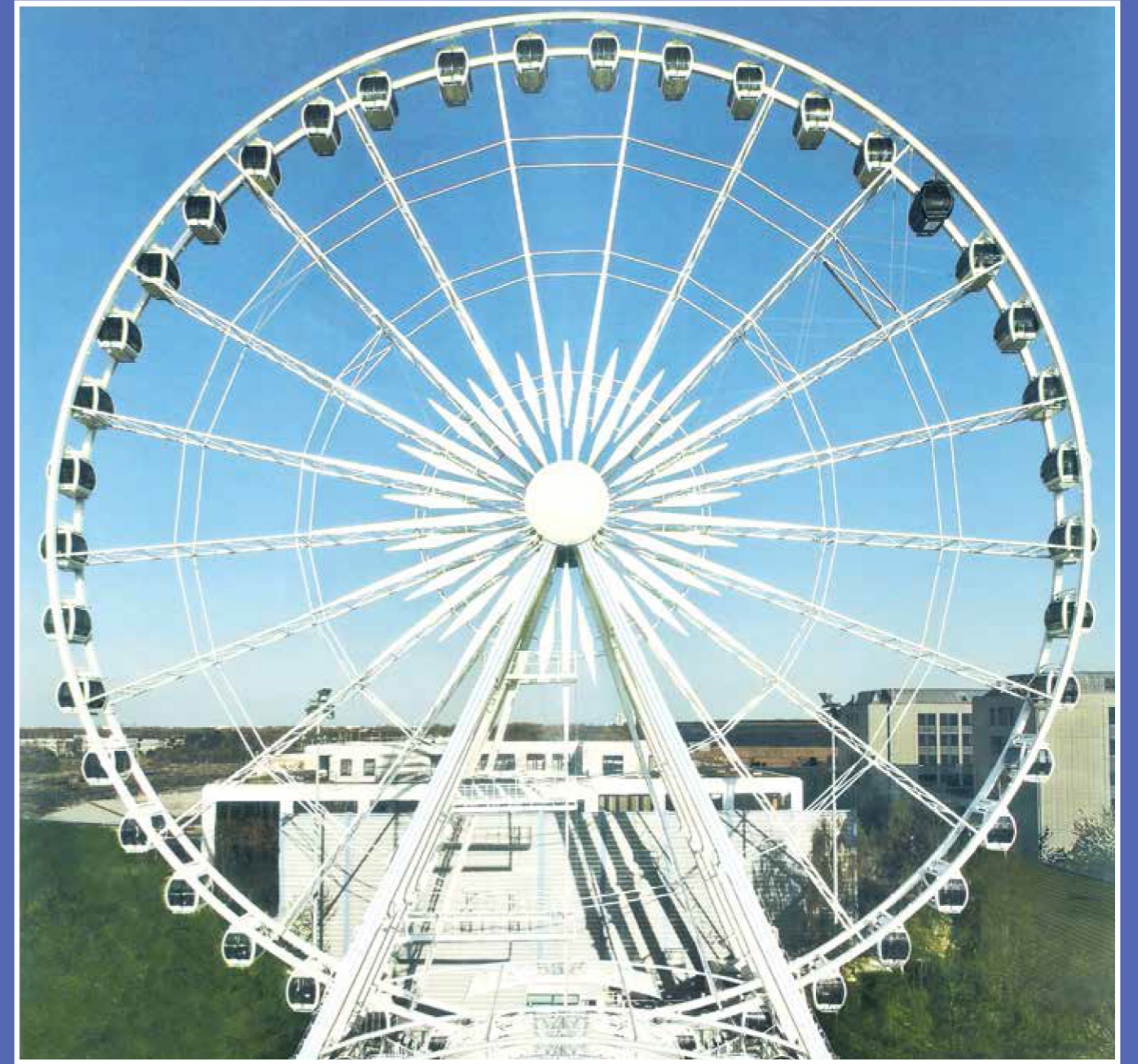



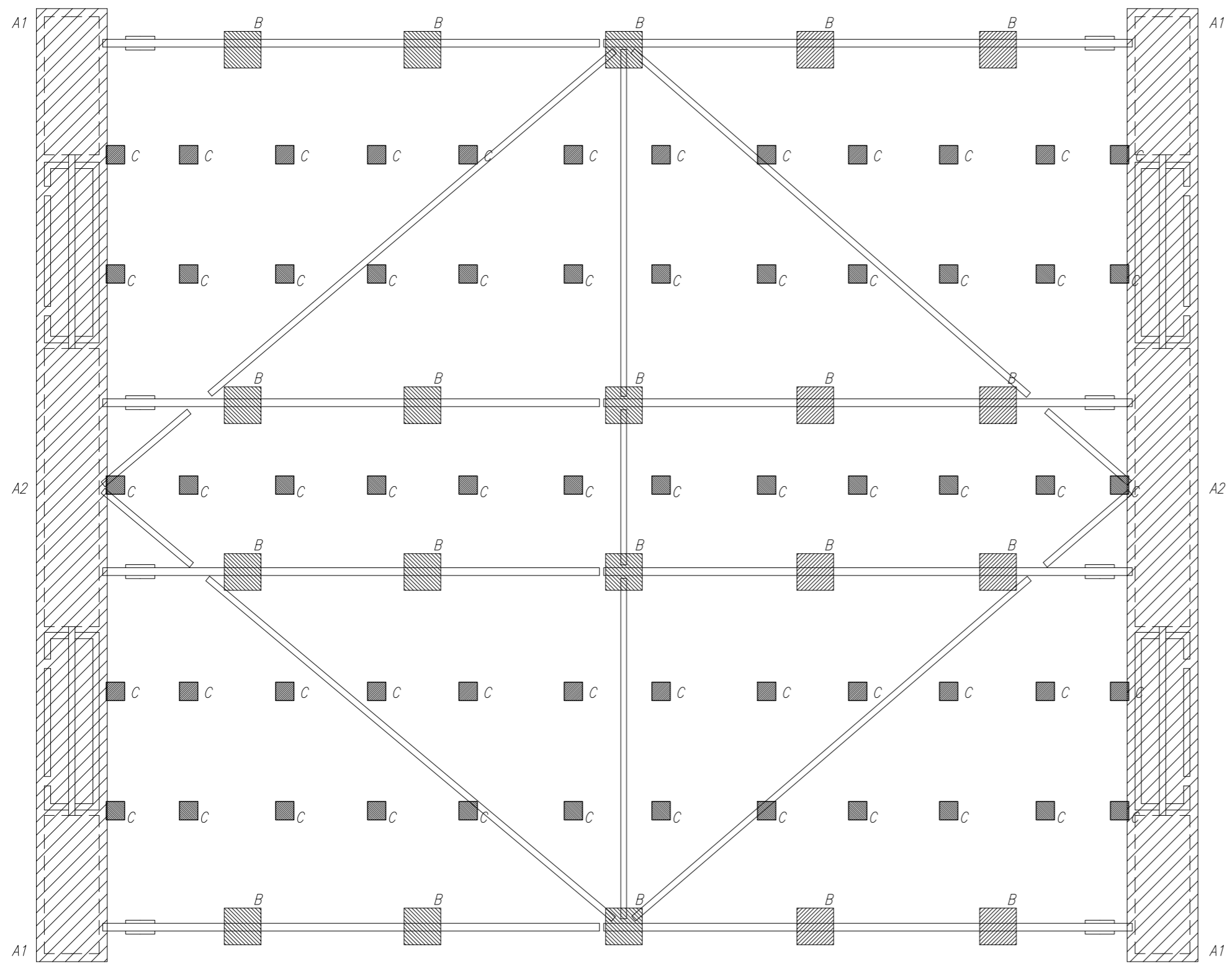

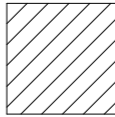

-  A= 1500 x 1500 mm
-  B= 600 x 600 mm
-  C= 500 x 500 mm

| PRESSURE (kN) | OWN WEIGHT + LIVE LOAD | OWN WEIGHT + MAX. WIND |
|---------------|------------------------|------------------------|
| A1            | 1000 kN                | 1240 kN                |
| A2            | 1325 kN                | 1950 kN                |
| B             | 70 kN                  |                        |
| C             | 50 kN                  |                        |

Ground pressure:  
according DIN 4112 pt. 6.3  
 $\sigma = 200 \text{ kN/m}^2$

Dimensions are in meters.

US Printing nach SEL 072klasse 3  
Nicht-SEL 096 Güteklasse  
3.1.B Altlast nach DIN 50049

**Copyright © RONALD BUSSINK AG**

| State | Rev. | Draw. | Date | Description of revision | Design | Checked | Project |
|-------|------|-------|------|-------------------------|--------|---------|---------|
|       |      |       |      |                         |        |         |         |

Copyright of Ronald Bussink Anemometer Design GmbH when properly this document remains. No part thereof may be distributed, copied, duplicated or in any other way made use of, except with approval of Ronald Bussink Anemometer Design GmbH, S-4812, Ussestedt. Changes or omissions are changes without prior notice.

Project: Giant Wheel type R60-SP  
Client: -  
Site: BASE FRAME SUPPORT

**RONALD BUSSINK**  
PROFESSIONAL ENGINEER

| Formel | Proj. Method | Scale | Project No. | Date     | Sheet No. | Rev. |
|--------|--------------|-------|-------------|----------|-----------|------|
| A1     | -            | -     | -           | 28-01-04 | BB02      | 0    |

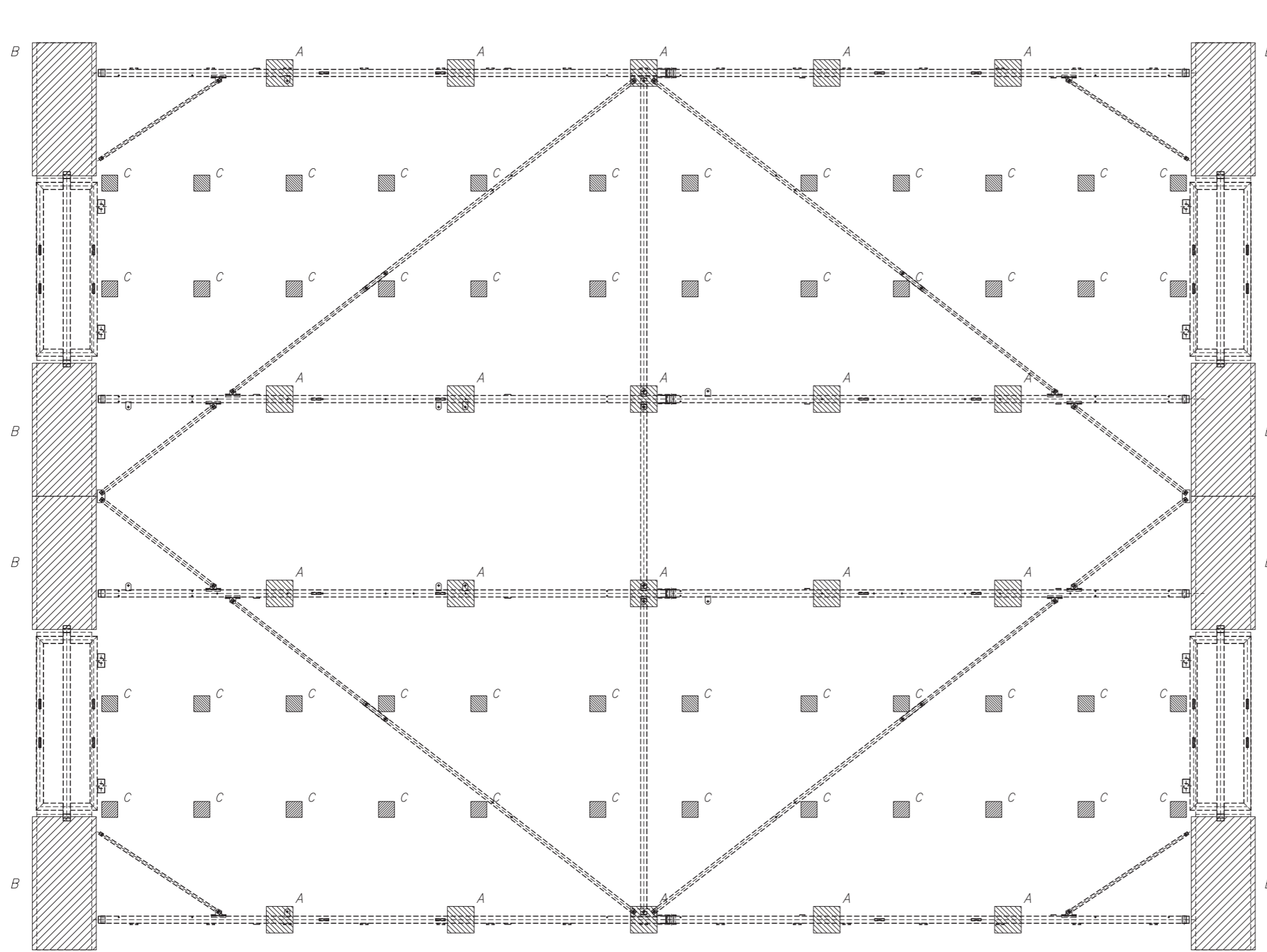

ENTRANCE SITE

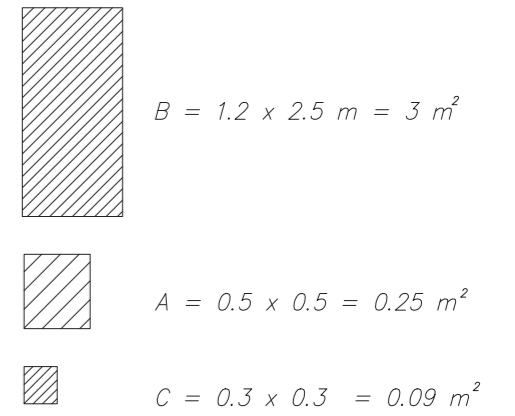

| Support          | Load (kN) | Own Weight + Live Load | Own Weight + Wind Perpendicular | Own Weight + Wind Parallel |
|------------------|-----------|------------------------|---------------------------------|----------------------------|
| Base Corners     | B1        | 80                     | 500                             | -                          |
| Base Middle      | B2        | 290                    | -                               | 420                        |
| Base Frame Beams | A         | 70                     |                                 |                            |
| Floors           | C         | 25                     |                                 |                            |

FLOOR PRESSURE  
According DIN 4112 chapter.6.3  $\sigma = 200 \text{ kN/m}^2$

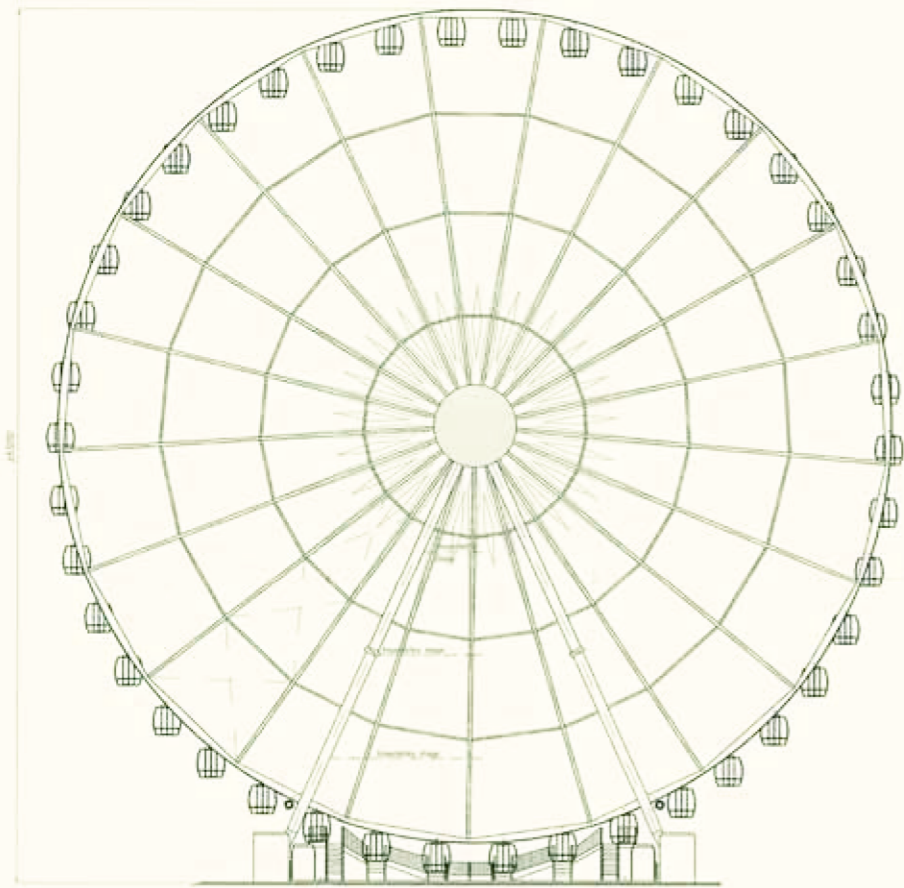

Front view

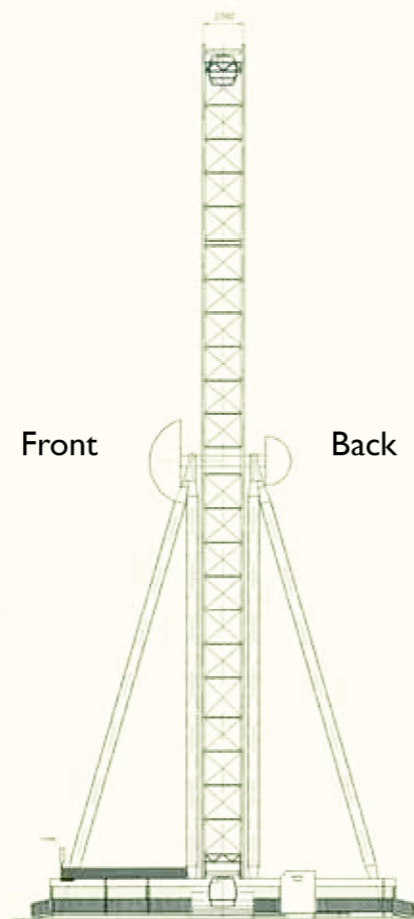

Side view

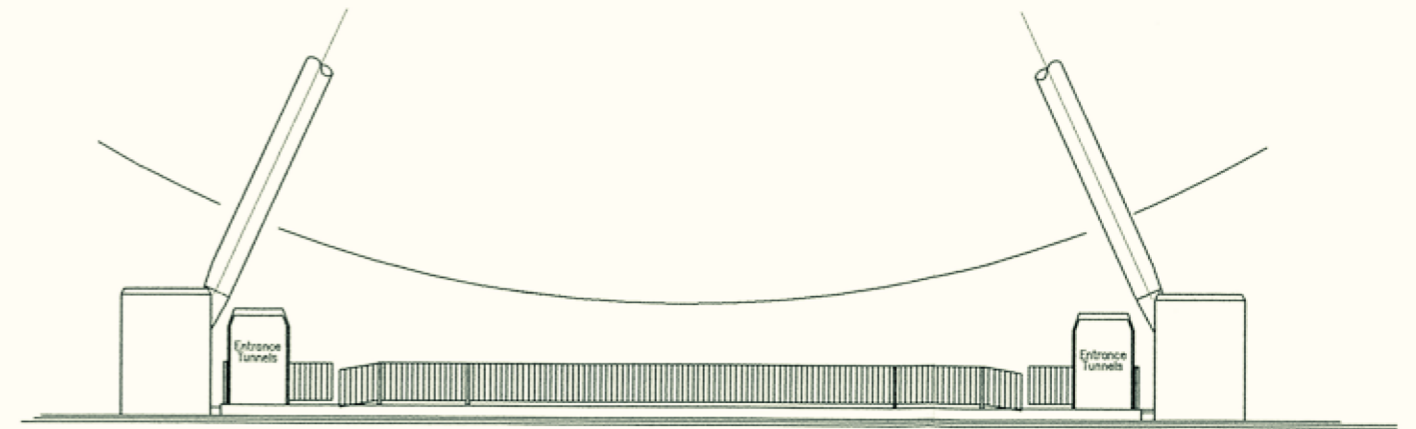

Rear view

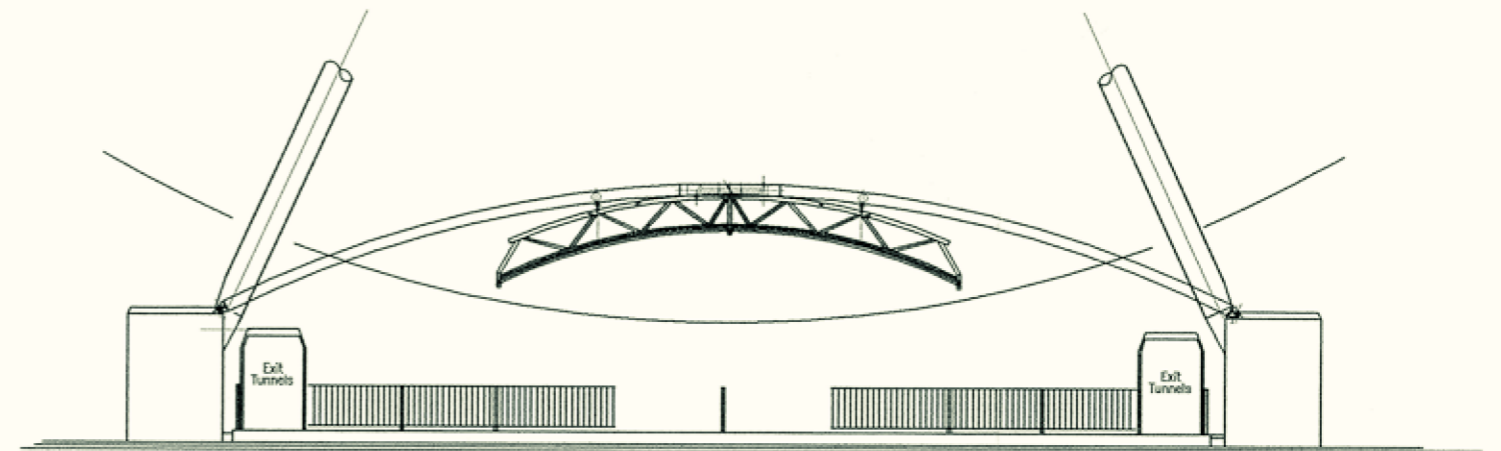

Front view ticket side

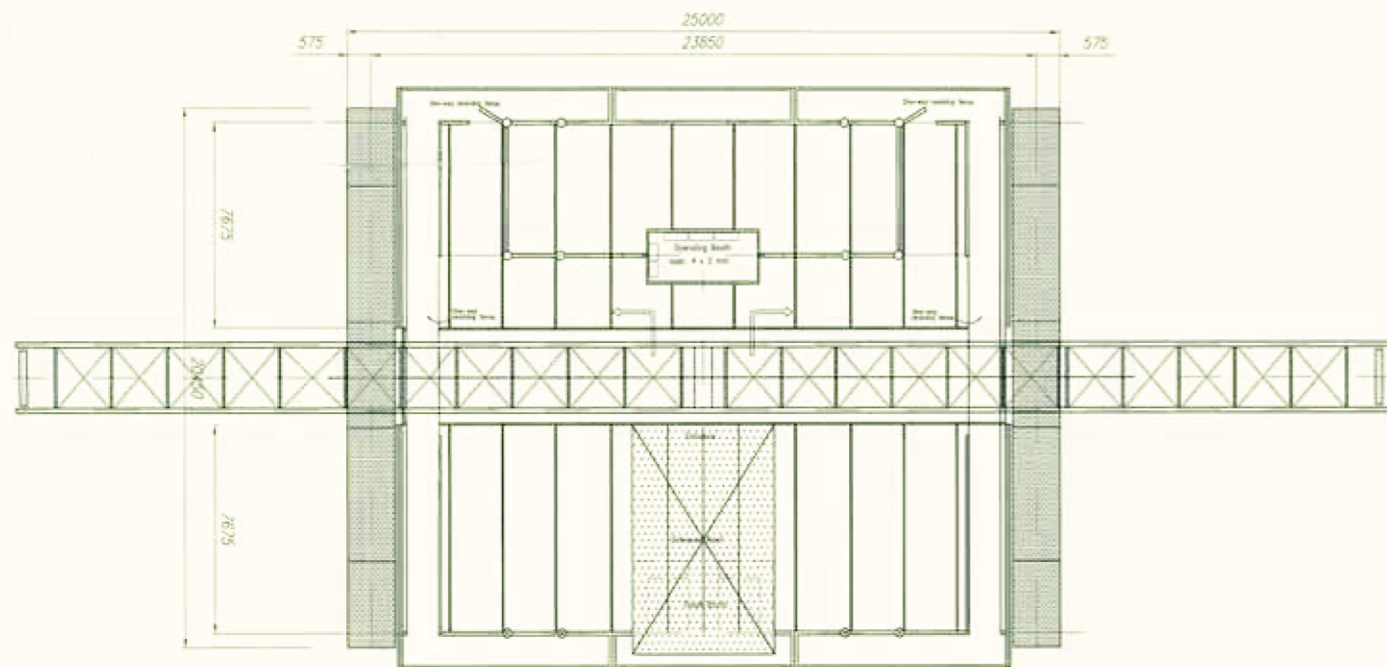

Top view loading platform

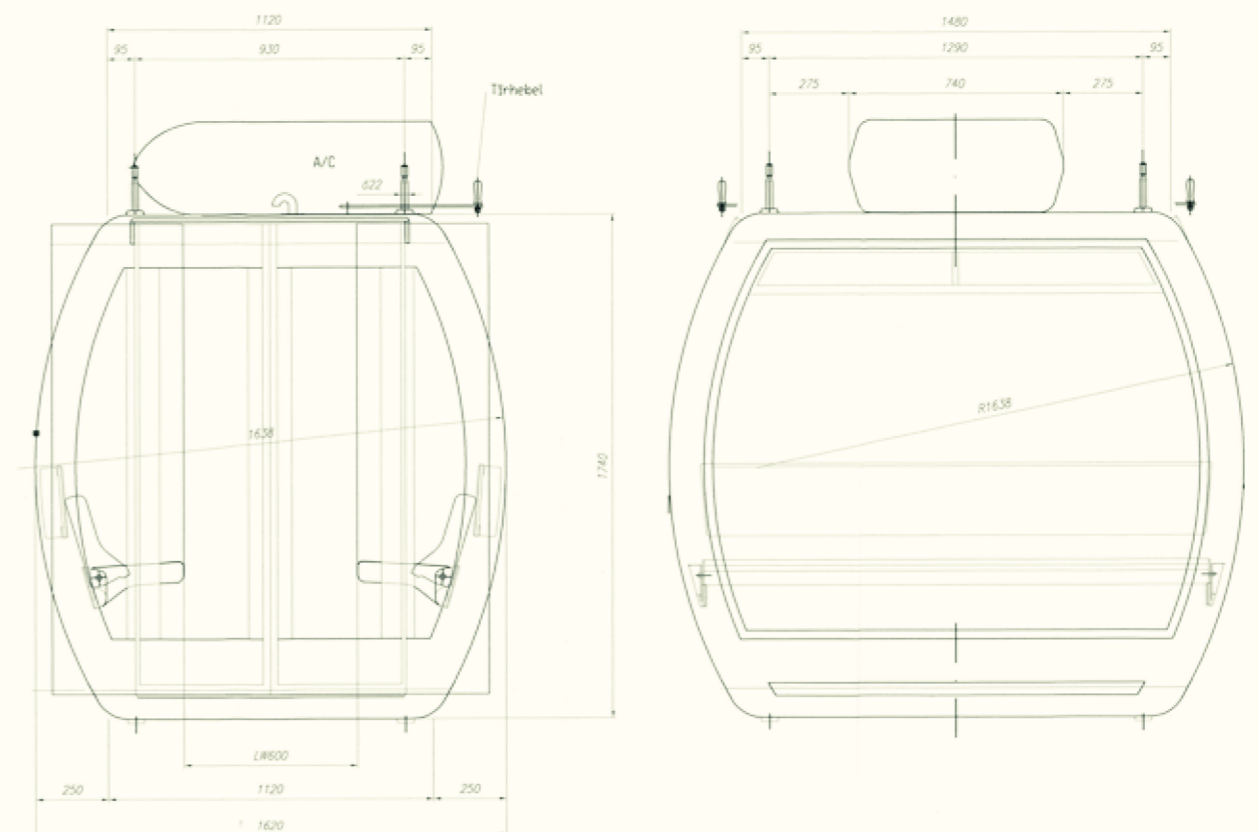

Gondola

